



Binks Model 149-873 & 149-874 HIGH-SPEED QUICK MIXER

⚠ WARNING

Disconnect air supply from the agitator before attempting any service maintenance.

⚠ WARNING

ENTANGLEMENT HAZARD!
Keep clear of paddles during operation.
Paddles are rotating and have sharp edges.

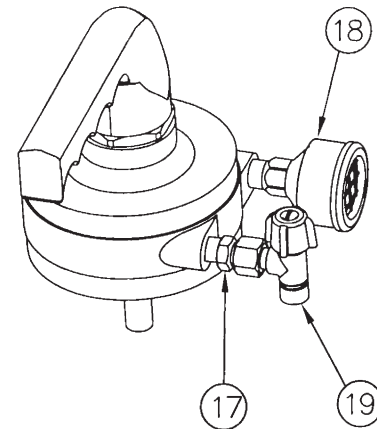
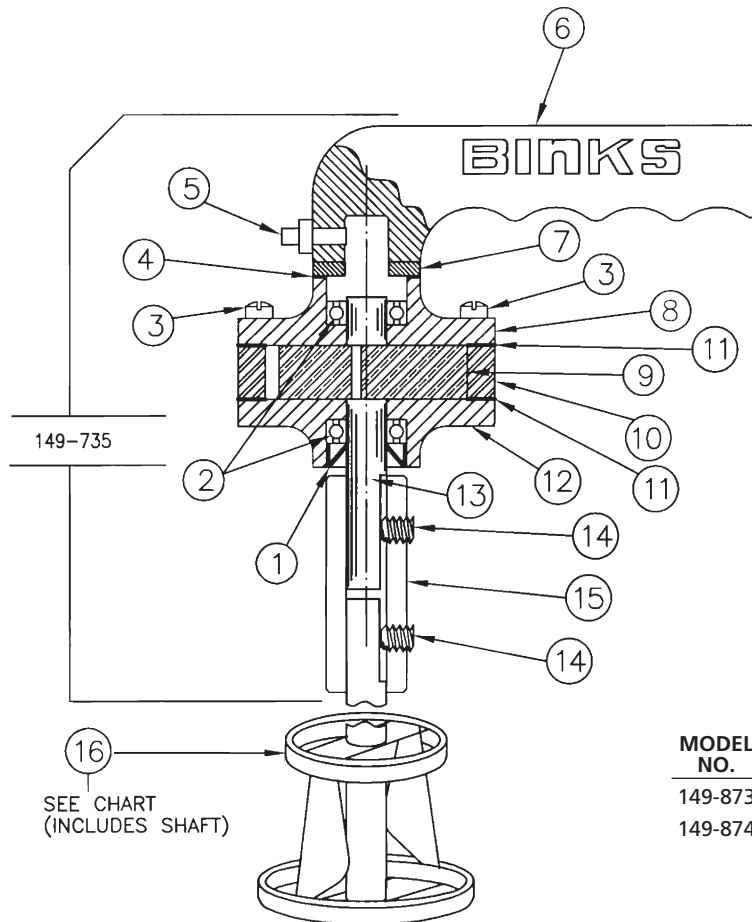

MIXER CHART

MODEL NO.	ITEM 16	SHAFT SIZE	MIXER DISC DIA.
149-873	149-365	1/2 DIA. x 21" LONG	5"
149-874	149-693	1/2 DIA. x 40" LONG	5"

PARTS LIST

When ordering, please specify Part No.

ITEM NO.	PART NO.	DESCRIPTION	QTY.	ITEM NO.	PART NO.	DESCRIPTION	QTY.
1	37-90 +●	OIL SEAL.....	1	12	37-413 +	PLATE, DRIVE END	1
2	37-91 +●	BEARING	2	13	37-89 +	ROTOR	1
3	37-415 +	FILLISTER HD. SCREW (2 SHOWN)	12	14	20-3344	SET SCREW ALLEN HD.	2
4	QS-181 +●	GASKET	1			(CUP PT 10-32 x 1/4 LONG)	
5	37-414	OILER	1	15	149-761	COUPLING (1/2" x 1/2")	1
6	149-734	HANDLE	1	16	—	QUICK MIXER (SEE CHART)	1
7	149-736	LOCKNUT.....	1	17	57-13	D.M. NIPPLE	1
8	37-412 +	PLATE, DEAD END	1	18	83-1527	MUFFLER	1
9	37-92 +●	VANE	4	19	73-159	METERING VALVE ASSEMBLY	1
10	37-93 +	BODY	1				
11	37-337 +●●	GASKET, END PLATE	2				

+ Indicates parts that are included in 83-1922 air motor.
The 83-1922 air motor is available as a replacement item.

● Available as part of Repair Kit 6-183.

◆ Also available in quantity pack of five (37-337-5).

NOTE: The hand mixer air motor assembly (149-735) is available as a replacement item. 149-735 includes items 1 through 15 plus items 17, 18 and 19.

Replaces
Part Sheet
77-2826R-1

Part
Sheet
77-2826R-2

In this part sheet, the words **WARNING**, **CAUTION** and **NOTE** are used to emphasize important safety information as follows:

 WARNING	 CAUTION	NOTE
Hazards or unsafe practices which could result in severe personal injury, death or substantial property damage.	Hazards or unsafe practices which could result in minor personal injury, product or property damage.	Important installation, operation or maintenance information.

WARNING

Read the following warnings before using this equipment.



READ THE MANUAL

Before operating finishing equipment, read and understand all safety, operation and maintenance information provided in the operation manual.



WEAR SAFETY GLASSES

Failure to wear safety glasses with side shields could result in serious eye injury or blindness.



DE-ENERGIZE, DEPRESSURIZE, DISCONNECT AND LOCK OUT ALL POWER SOURCES DURING MAINTENANCE

Failure to De-energize, disconnect and lock out all power supplies before performing equipment maintenance could cause serious injury or death.



OPERATOR TRAINING

All personnel must be trained before operating finishing equipment.



EQUIPMENT MISUSE HAZARD

Equipment misuse can cause the equipment to rupture, malfunction, or start unexpectedly and result in serious injury.

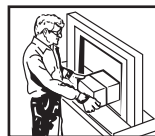

KEEP EQUIPMENT GUARDS IN PLACE

Do not operate the equipment if the safety devices have been removed.

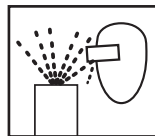

PROJECTILE HAZARD

You may be injured by venting liquids or gases that are released under pressure, or flying debris.



PINCH POINT HAZARD

Moving parts can crush and cut. Pinch points are basically any areas where there are moving parts.



AUTOMATIC EQUIPMENT

Automatic equipment may start suddenly without warning.



INSPECT THE EQUIPMENT DAILY

Inspect the equipment for worn or broken parts on a daily basis. Do not operate the equipment if you are uncertain about its condition.



NEVER MODIFY THE EQUIPMENT

Do not modify the equipment unless the manufacturer provides written approval.



KNOW WHERE AND HOW TO SHUT OFF THE EQUIPMENT IN CASE OF AN EMERGENCY



PRESSURE RELIEF PROCEDURE

Always follow the pressure relief procedure in the equipment instruction manual.



NOISE HAZARD

You may be injured by loud noise. Hearing protection may be required when using this equipment.



STATIC CHARGE

Fluid may develop a static charge that must be dissipated through proper grounding of the equipment, objects to be sprayed and all other electrically conductive objects in the dispensing area. Improper grounding or sparks can cause a hazardous condition and result in fire, explosion or electric shock and other serious injury.



FIRE AND EXPLOSION HAZARD

Never use 1,1,1-trichloroethane, methylene chloride, other halogenated hydrocarbon solvents or fluids containing such solvents in equipment with aluminum wetted parts. Such use could result in a serious chemical reaction, with the possibility of explosion. Consult your fluid suppliers to ensure that the fluids being used are compatible with aluminum parts.



TOXIC FLUID & FUMES

Hazardous fluid or toxic fumes can cause serious injury or death if splashed in the eyes or on the skin, inhaled, injected or swallowed. LEARN and KNOW the specific hazards of the fluids you are using.



WEAR RESPIRATOR

Toxic fumes can cause serious injury or death if inhaled. Wear a respirator as recommended by the fluid and solvent manufacturer's Material Safety Data Sheet.



PROP 65 WARNING

WARNING: This product contains chemicals known to the State of California to cause cancer and birth defects or other reproductive harm.

IT IS THE RESPONSIBILITY OF THE EMPLOYER TO PROVIDE THIS INFORMATION TO THE OPERATOR OF THE EQUIPMENT.

FOR FURTHER SAFETY INFORMATION REGARDING BINKS AND DEVILBISS EQUIPMENT, SEE THE GENERAL EQUIPMENT SAFETY BOOKLET (77-5300).

Binks MODEL 149-873 & 149-874 HIGH-SPEED QUICK MIXER

The Binks High Speed Quick-Mixers are hand-held, compact, and versatile units for use in the shop or on the job.

A unique feature of the Quick Mixer is the vertical and horizontal blade design which moves the material toward the center of the mixer at all times assuring thorough blending. The mixer is also designed to scrape the bottom and sides of the container without injuring the mixer or puncturing container walls.

A table of approximate mixing speeds is shown below for your convenience. The use of an electric drill is not recommended for mixing paint or other highly flammable materials.

MODEL NUMBERS	DIAMETER OF MIXER UNIT	OUTER RIM TRAVEL IN FPM @ 600 RPM
149-365 MIXER	5	785.4
149-693 MIXER	5	785.4

OPERATING INSTRUCTIONS

1. Tighten air motor chuck onto mixer shaft securely.
2. The mixer should be immersed in material to be mixed before turning on power, and kept immersed while in motion.
3. Hold unit firmly—keep under rigid control. If the container is of a small size, or the material highly viscous, the container should be anchored or otherwise held in place container from being thrown or overturned.

WARNING

Do not use electric drill with flammable materials.

MIXING OF MATERIALS

1. Prepared, packaged stock materials, such as paints or other coatings, with powders or pigments may settle to the bottom of container. Submerge mixer to bottom of container and start air motor. Move unit slowly around container until these solids have been released and are mixed.
2. For mixing two or more materials, such as a catalyst or hardener- use the above procedure. Pour the catalyst into container as close to mixer shaft as possible for thorough blending. Speed may be changed to suit viscosity of materials to be worked.
3. Dry powders, such as adhesives, joint compounds, mud, grout, etc., should be mixed as stated above in 2. Mixer speed should be reduced until all dry powder is added to liquid, then unit speed may be increased.
4. Coloring or tinting of materials. Same as 2 above.
5. Cleaning unit. Immerse in compatible solvent and turn unit on for approximately 30 to 60 seconds.

NOTE

If material reaches a degree of turbulence which forces it out of container, the speed should be reduced or the unit "triggered".

WARRANTY

This product is covered by Binks' 1 Year Limited Warranty.

Binks Sales and Service: www.binks.com



U.S.A./Canada Customer Service
195 Internationale Blvd.
Glendale Heights, IL 60139
630-237-5000

Toll Free Customer Service
and Technical Support
800-992-4657

Toll Free Fax
888-246-5732

77-2826R-2 Revisions: (P1) Revised Parts List.
--