

ATOMEX™

Internal Pipe Sprayer



60mm - 250mm
High Pressure 3300psi

INSTRUCTION MANUAL



Warnings

The following are general warnings related to the setup, use, grounding, maintenance, and repair of this equipment.

FIRE AND EXPLOSION HAZARD

Flammable fumes, such as solvent and paint fumes, in **work area** can ignite or explode. To help prevent fire and explosion:

- Use equipment only in well ventilated area.
- Eliminate all ignition sources; such as pilot lights, cigarettes, portable electric lamps, and plastic drop cloths (potential static arc).
- Keep work area free of debris, including solvent, rags and gasoline.
- Do not plug or unplug power cords, or turn power or light switches on or off when flammable fumes are present.
- Ground all equipment in work area. See **Grounding** instructions.
- Use only grounded hoses.
- Hold gun firmly to side of grounded pail when triggering into pail.
- If there is static sparking or you feel a shock, **stop operation immediately**. Do not use equipment until you identify and correct the problem.
- Keep a fire extinguisher in the work area.

SKIN INJECTION HAZARD

High-pressure fluid from gun, hose leaks, or ruptured components will pierce skin. This may look like just a cut, but it is a serious injury that can result in amputation. **Get immediate surgical treatment.**

- Do not point gun at anyone or at any part of the body.
- Do not put your hand over the spray tip.
- Do not stop or deflect leaks with your hand, body, glove, or rag.
- Do not spray without tip guard and trigger guard installed.
- Engage trigger lock when not spraying.
- Follow **Pressure Relief Procedure** in this manual, when you stop spraying and before cleaning, checking, or servicing equipment.

EQUIPMENT MISUSE HAZARD

Misuse can cause death or serious injury.

- Do not exceed the maximum working pressure or temperature rating of the lowest rated system component. See **Technical Data** in all equipment manuals. Read fluid and solvent manufacturer's warnings. For complete information about your material, request MSDS from distributor or retailer.
- Use fluids and solvents that are compatible with equipment wetted parts. See **Technical Data** in all equipment manuals. Read fluid and solvent manufacturer's warnings.
- Check equipment daily. Repair or replace worn or damaged parts immediately.
- Do not alter or modify equipment.
- For professional use only.
- Use equipment only for its intended purpose. Call your Graco distributor for information.
- Route hoses and cables away from traffic areas, sharp edges, moving parts, and hot surfaces.
- Do not kink or overbend hoses.
- Comply with all applicable safety regulations.
- Keep children and animals away from work area.
 - Do not operate the unit when fatigued or under the influence of drugs or alcohol



Warnings

PRESSURIZED ALUMINUM PARTS HAZARD

Do not use 1,1,1-trichloroethane, methylene chloride, other halogenated hydrocarbon solvents or fluids containing such solvents in pressurized aluminum equipment. Such use can cause serious chemical reaction and equipment rupture, and result in death, serious injury, and property damage.

TOXIC FLUID OR FUMES HAZARD

Toxic fluids or fumes can cause serious injury or death if splashed in the eyes or on skin, inhaled, or swallowed.

- Read MSDS's to know the specific hazards of the fluids you are using.
- Store hazardous fluid in approved containers, and dispose of it according to applicable guidelines.

PERSONAL PROTECTIVE EQUIPMENT

You must wear appropriate protective equipment when operating, servicing, or when in the operating area of the equipment to help protect you from serious injury, including eye injury, inhalation of toxic fumes, burns, and hearing loss. This equipment includes but is not limited to:

- Protective eyewear
- Clothing and respirator as recommended by the fluid and solvent manufacturer
- Gloves
- Hearing protection



Internal Pipe Sprayer (60 - 250mm)

Internal Pipe Spraying System

Detail of components in this package

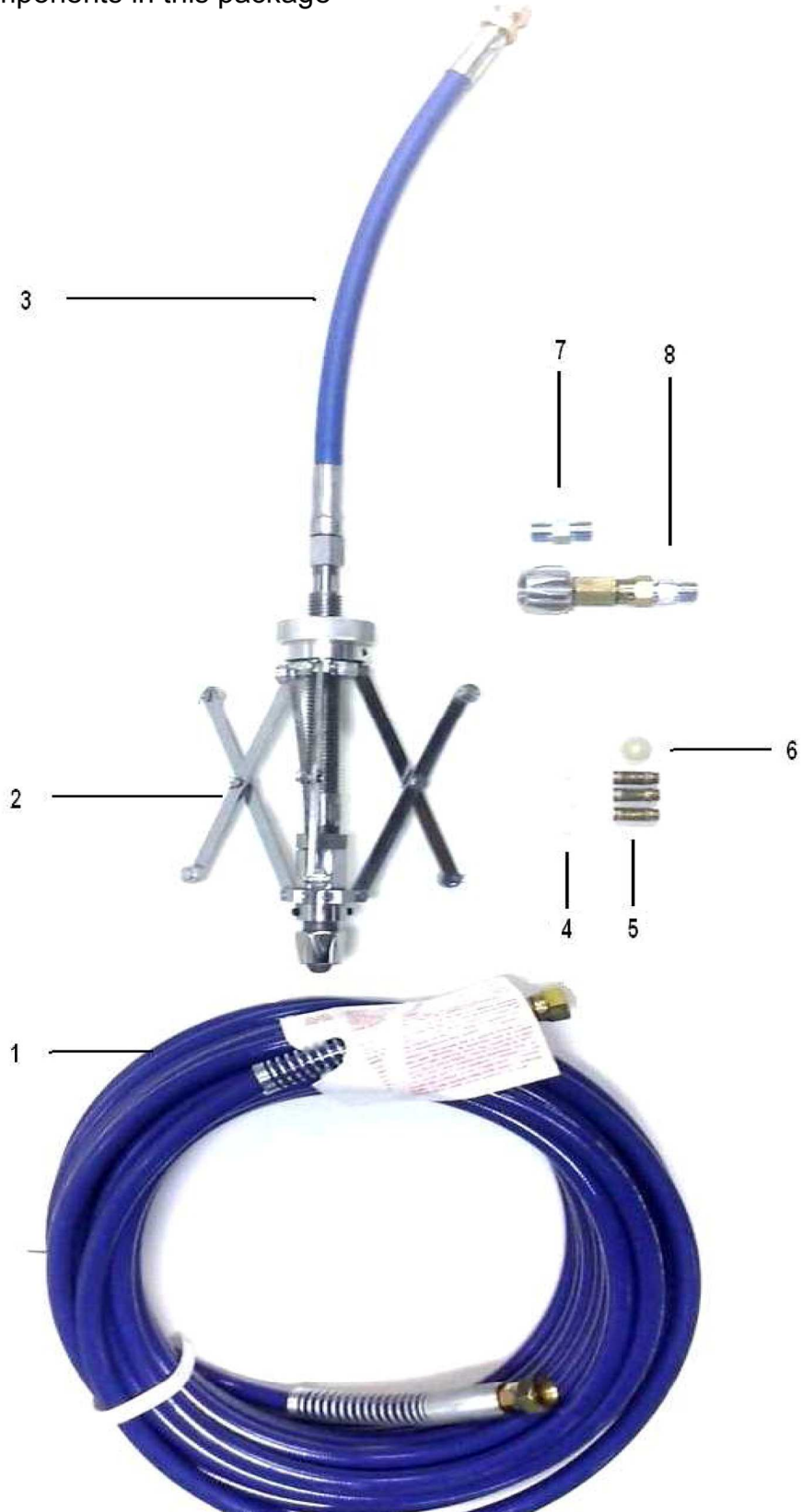



Internal Pipe Sprayer (60 - 250mm)

Detail of components in this package

Item Number	Qty	Description	Part No.
1	1	15m Paint Hose ¼" NPT – 3300psi Max Pressure	
2	1	Internal Pipe Sprayer – Conical Jet	
3	1	350mm High Pressure Adaptor Hose	
4	3	Pre-Orifice Flow Restrictors	
5	3	Mesh Filter – Screw In assorted mesh size	
6	1	Mesh Filter Seal	
7	1	High Pressure Nipple ¼: NPT	
8	1	Airless Gun to Hose Adaptor – “G” Thread	

How to Operate

- 1) Adjust the height of the three extension leg to suit the internal width of the pipe. This is done by turning the adjusting nut either clockwise to expand the legs out or counter clockwise to retract the legs in.
- 2) Ensure that the legs are adjusted adequately for the pipe sprayer to be pulled through the pipe without becoming jammed or stuck.
- 3) Connect the airless gun adaptor (part 8) to your airless spray gun.
- 4) Connect the paint hose to the airless gun adaptor and then connect the other end of the paint hose to the High Pressure Adaptor hose (part 3), you will need to use the nipple provide (part 7) in order to connect these two hose.
- 5) Ensure that all fitting are tight. No thread tape is required, if a leak occurs either tighten the connection remove the connection, clean the fittings and reconnect.
- 6) Ensure the cone jet retaining nut is tight.
- 7) We recommend testing the pipe sprayer with paint before inserting into the pipe, this will allow you to adjust the pressure correctly on your machine to ensure the correct amount of paint is being applied. You can change or remove the pre-orifice restrictors according to the viscosity of the material being sprayed.
- 8) Once you have adjusted your airless sprayer to the correct pressure you can insert the pipe sprayer into the pipe. Depending on the length of pipe being sprayed you may wish to either push the pipe sprayer through the pipe using the paint hose or you can run a small rope through the pipe and tie this to the pipe sprayer pulling back through the pipe.
- 9) When the pipe sprayer is located in the right position where you wish to begin spraying, pull the trigger on the airless hand gun and at the same time use the paint hose to pull the pipe sprayer back through the pipe. You will have to work out at which speed this hose needs to be pulled. If you are worried about pulling on the hose, you can also attach a small rope to the back of the pipe sprayer and use this to pull the device.
- 10) Do Not Stand at the opposite end of the pipe or look down the pipe while the pipe sprayer is in use. If a component for some reason was to come off under pressure it may be fatal for a person or animal if struck by an object traveling at high speed.
- 11) Clean the pipe spraying system after use according the manufacturers recommendation of the product being used.
- 12) Check the pipe sprayer at regular intervals during operation to ensure that no leaks occur and that the cone jet nut/holder is always tight.

Cone Jet Holder, Nozzle and Filter Breakdown

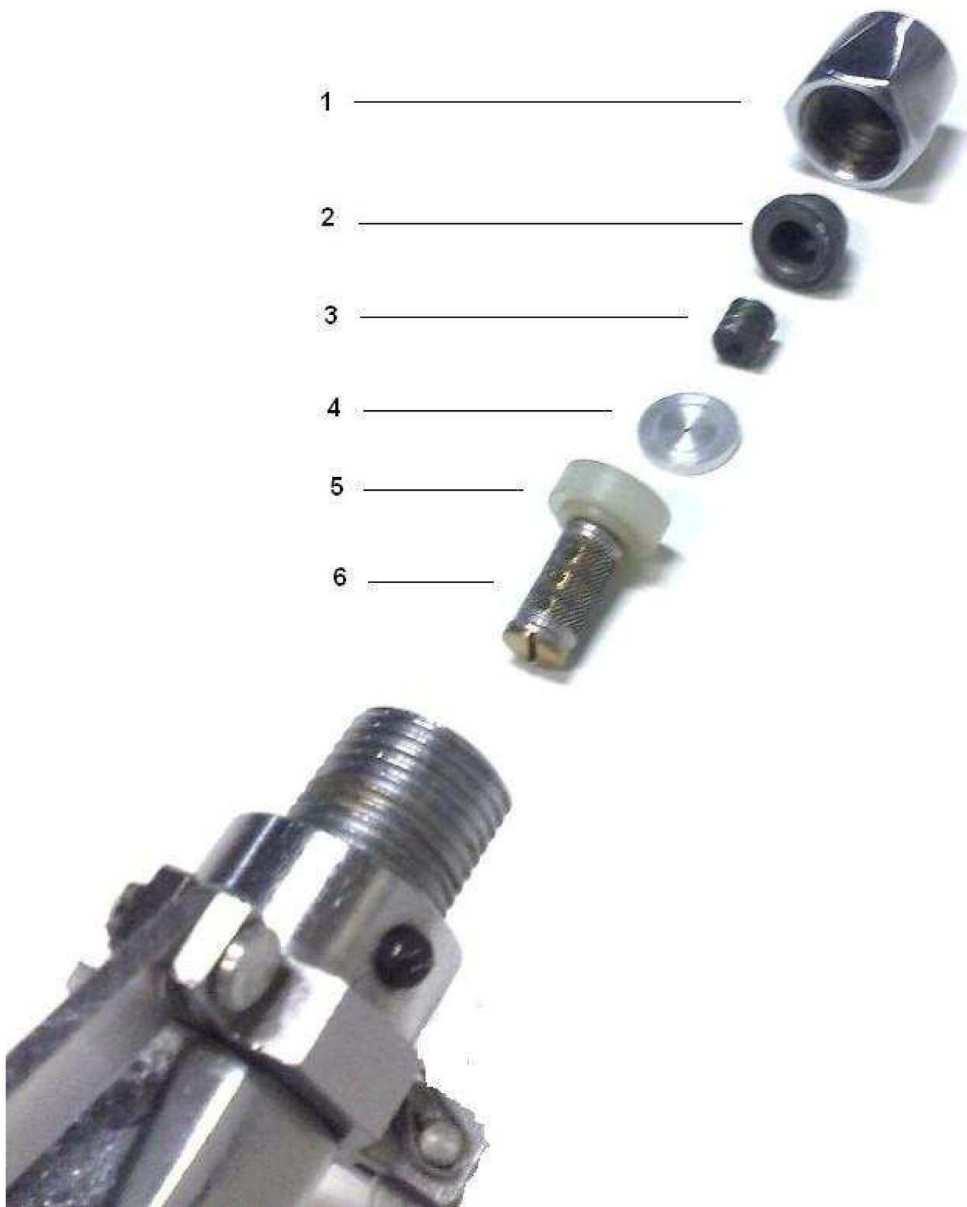



Internal Pipe Sprayer (60 - 250mm)

Detail of components in this package

Item Number	Description	Part No.
1	Cone Jet Nut Holder	AX/PS60250/1001
2	Cone Jet	AX/PS60250/1002
3	Cone Jet Swirl Valve	AX/PS60250/1003
4	Pre-Orifice Flow Restrictors (optional)	AX/PS60250/1004
5	Mesh Filter Seal	AX/PS60250/1005
6	Mesh Filter – Screw In assorted mesh size	AX/PS60250/1006

Examples of the different positions that the legs can be adjusted to





For Technical Assistance please contact



29 Carlingford Rd, Regents Park NSW 2143
Phone (02) 9644 1040 FAX (02) 9644 3147
Email: info@atomex.com.au

www.atomex.com.au

Notes
