



# Wagner 0580041B Control Pro 250/350 Door

**\$7.92**  
**INCL. GST**

## Product Images



## Short Description

---

Wagner 0580041B Control Pro 250/350 Door is used in both Control Pro 250 & 350 models. The storage box in the motor cover of your Control Pro 250/350 requires two doors.

## Description

---

Wagner 0580041B Control Pro 250/350 Door is used in both Control Pro 250 & 350 models. The storage box in the motor cover of your Control Pro 250/350 requires two doors.

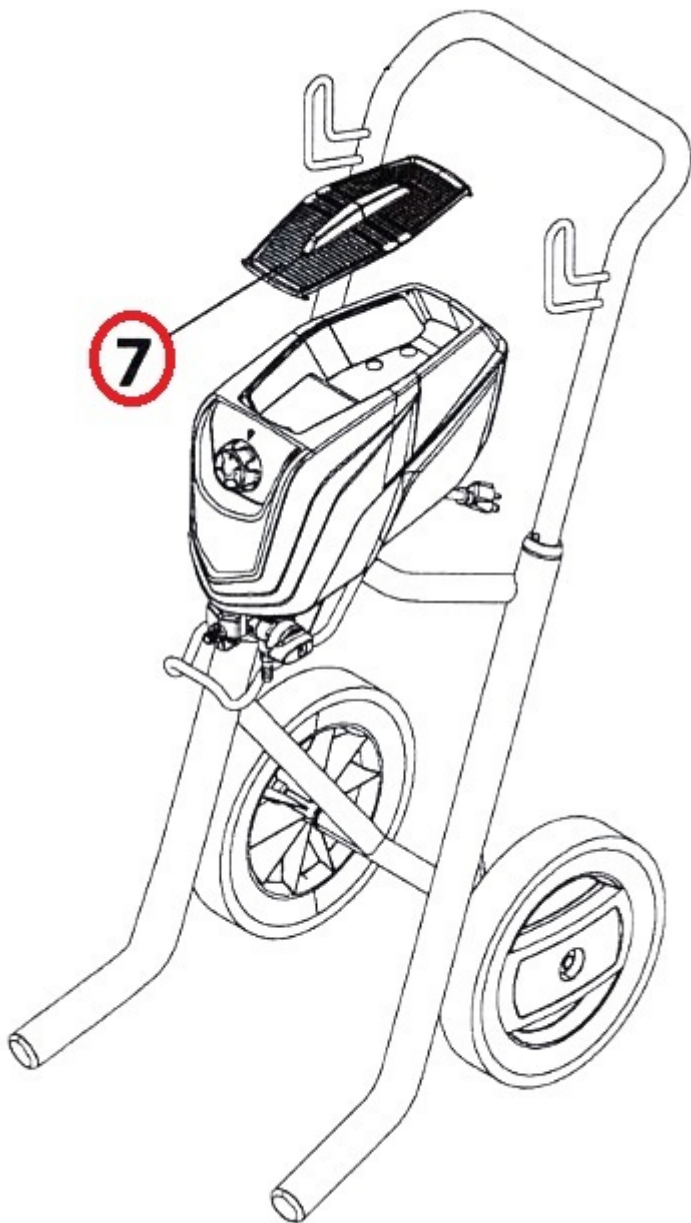

**Wagner 0580041B Control Pro 250/350 Door is used with the following models -**

[Wagner Control Pro 350 Extra Skid](#) (Part no. 2371063)

[Wagner Control Pro 350 Extra Cart](#) (Part no. 2371067)

Wagner Part No. 0580041B

---

[Click here to see Control Pro 250/350 Spare Parts & Accessories](#)

## Additional Information

---

Brands	Wagner
Equipment Type	Airless Sprayers
Machine Type	Electric 240V
Machine Model Number	Control Pro 350, Control Pro 250
OEM	Original Part

